

# ZONE MORTALIS - COLUMNS CONSTRUCTION

1

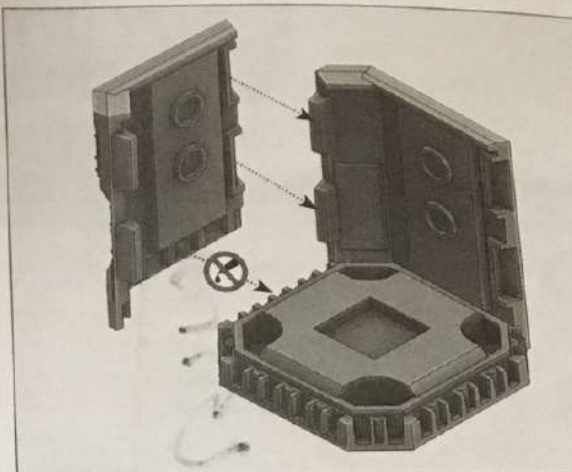
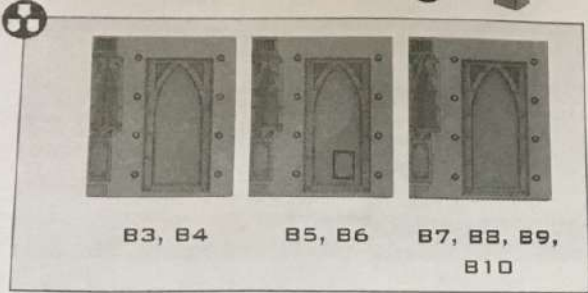
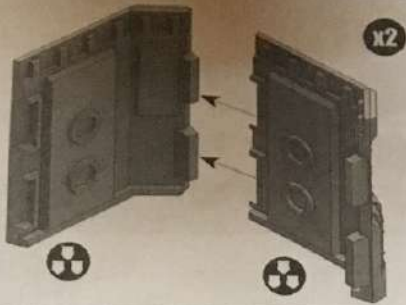

FOR EASY ASSEMBLY OF THE COLUMNS, YOU CAN TURN PARTS B1 AND B2 UPSIDE DOWN AND USE THE INDENTATIONS ON PART B1/B2'S SIDES AS A GUIDE WHEN ASSEMBLING THE COLUMN WALLS.

2

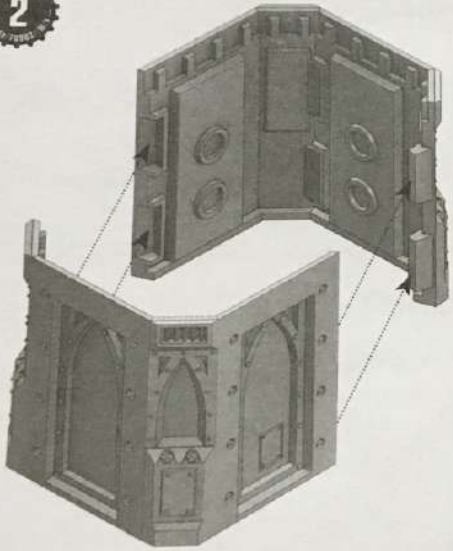

3

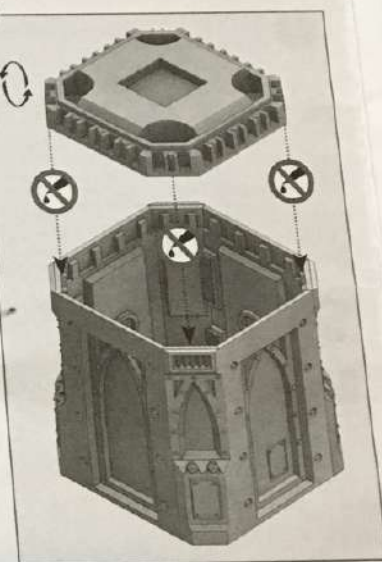
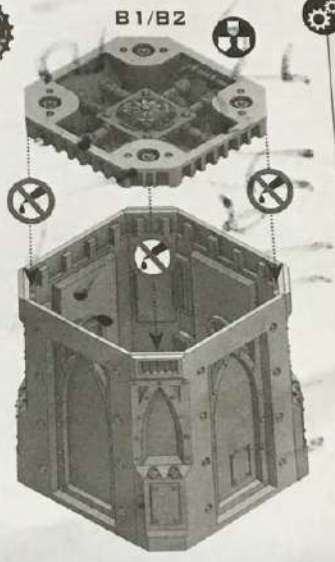

4

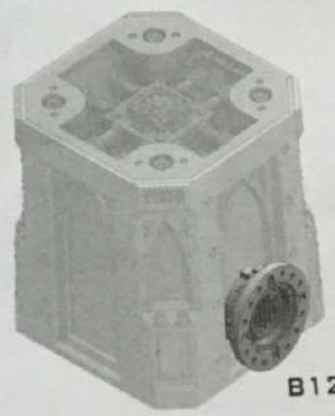
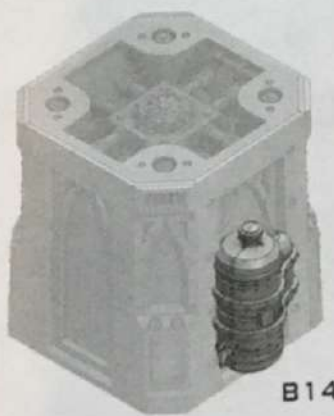

1

G9, G10, G11, G12

3

G9, G11

# ZONE MORTALIS - DOORS CONSTRUCTION

**1**

G9, G10,  
G11, G12



G13, G14,  
G15, G16



G7, G8



**2**

G5, G6

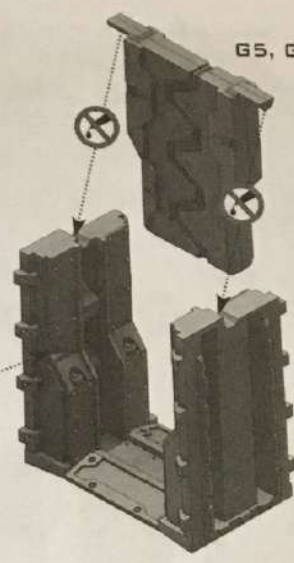

G17,  
G18, G19



**3**

G9, G10,  
G11, G12



G13, G14,  
G15, G16



G3, G4

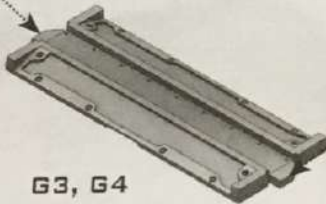

**4**

G1, G2

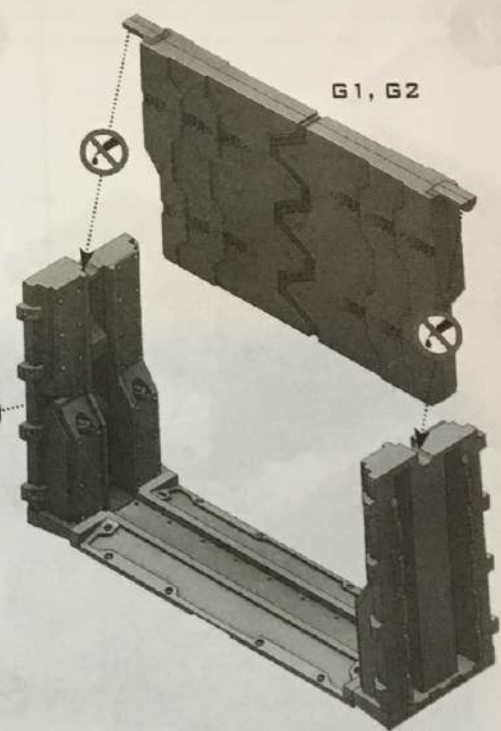

G17,  
G18,  
G19



PARTS B1  
T B1/B2'S  
ALLS.

# ZONE MORTALIS - WALLS CONSTRUCTION

1

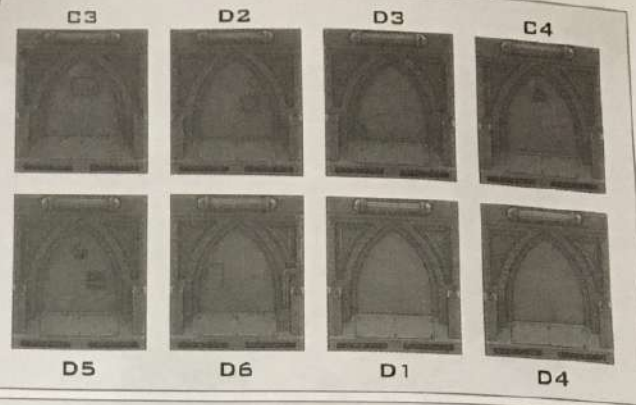
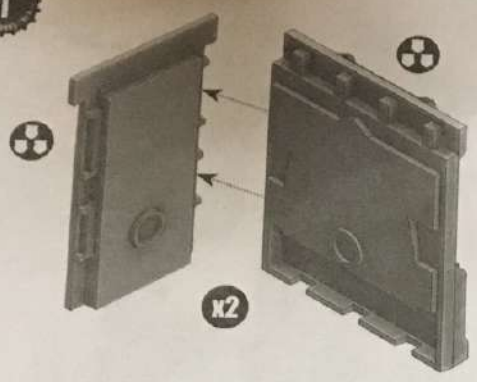

4

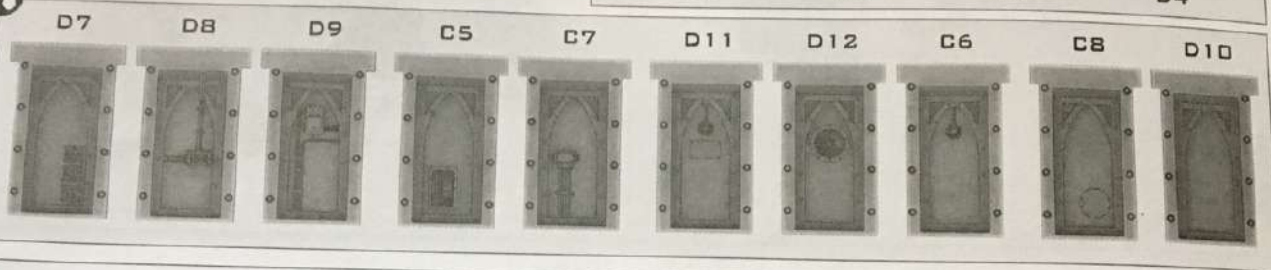

2

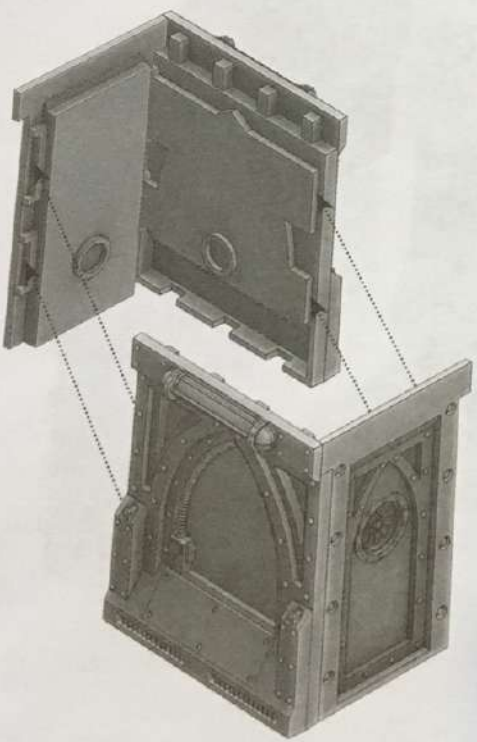

3

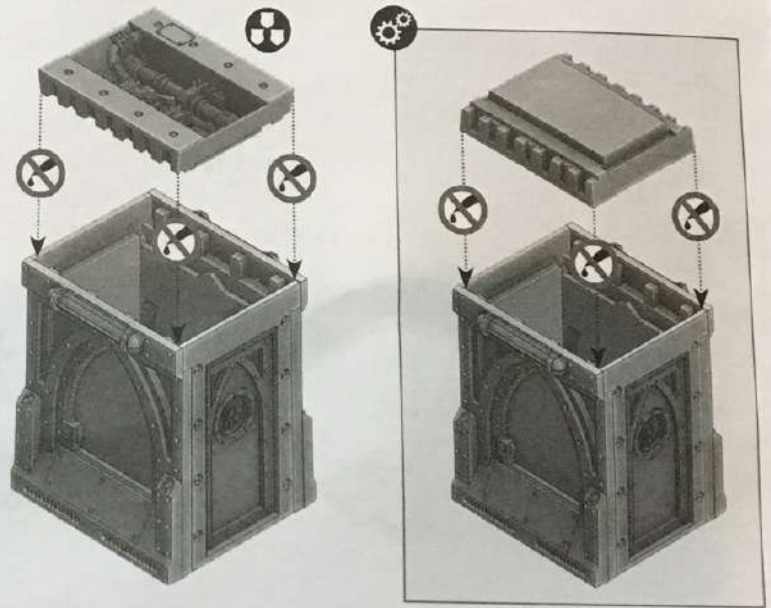

5

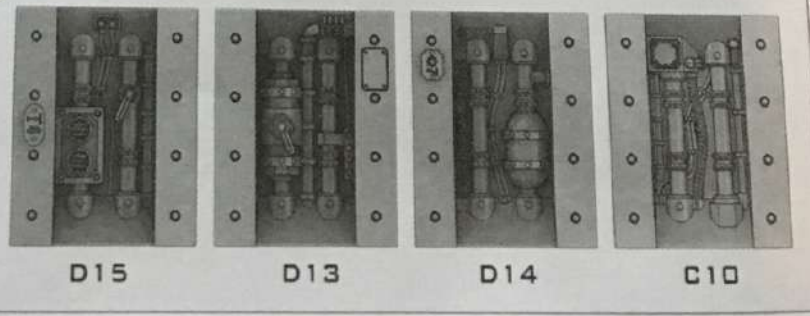

# ZONE MORTALIS - WALLS CONSTRUCTION CONTINUED

4

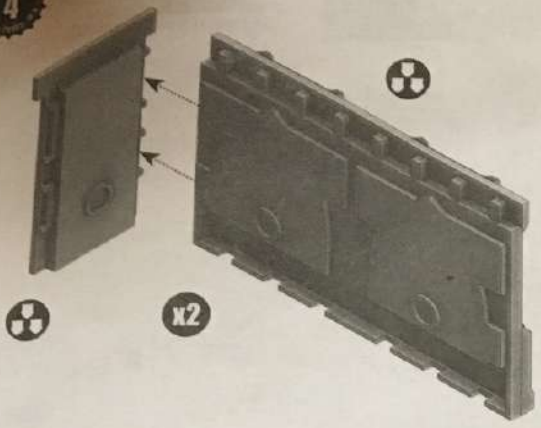

3

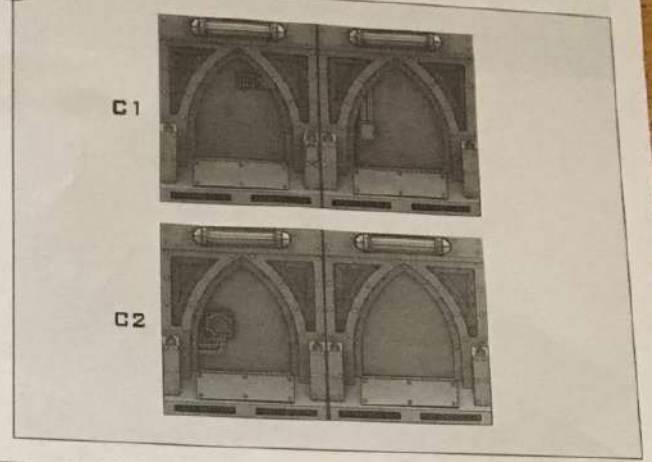

2

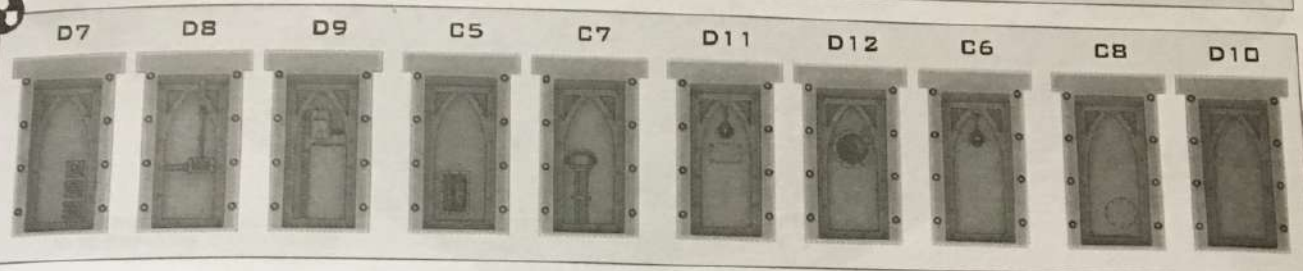

5

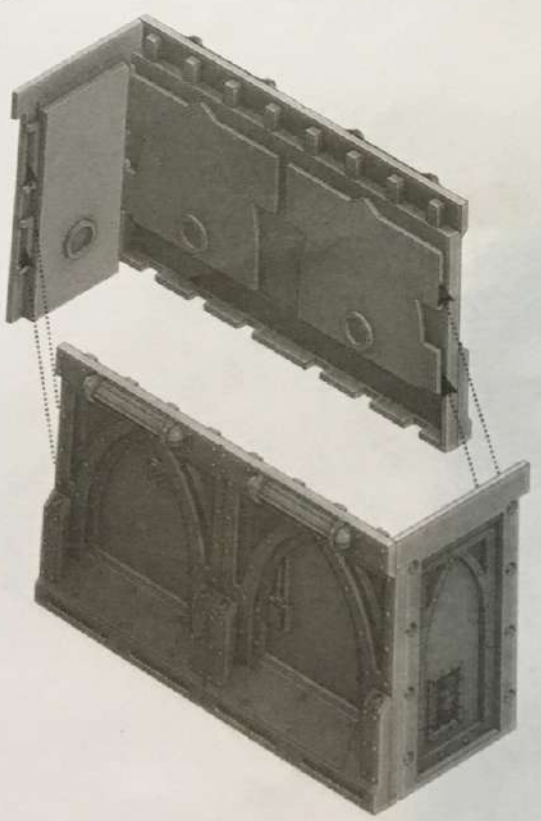

6

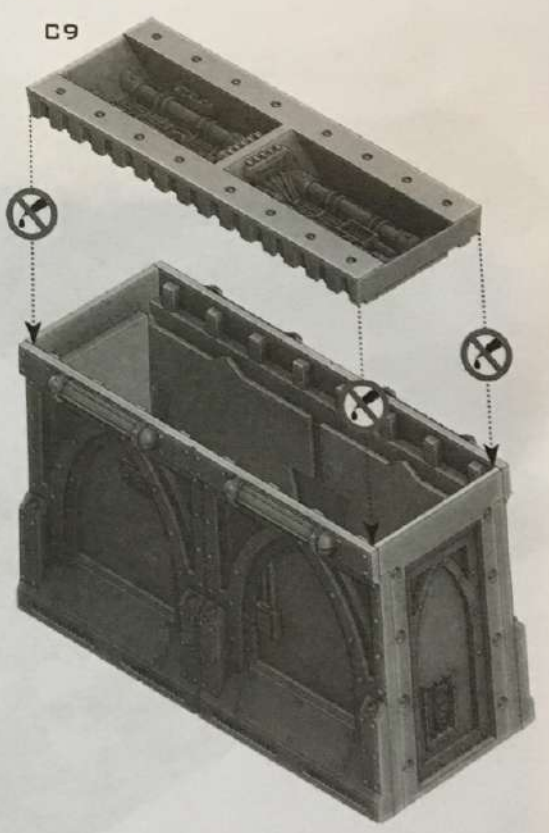

## USING ZONE MORTALIS SCENERY AND THE THERMIC PLASMA CONDUITS SCENERY KITS TOGETHER

THE FOLLOWING DIAGRAMS ILLUSTRATE HOW YOU MAY USE THE ZONE MORTALIS AND THERMIC PLASMA CONDUITS SCENERY KITS TOGETHER. DUE TO THE MODULAR NATURE OF ALL OF THESE KITS, THE INSTRUCTIONS THAT FOLLOW ARE A SUGGESTION ON HOW TO USE THEM TOGETHER.

### KITS IN USE:

- ZONE MORTALIS: COLUMNS AND WALLS
- ZONE MORTALIS: PLATFORMS & STAIRS
- ZONE MORTALIS: FLOORS
- THERMIC PLASMA CONDUITS

COLUMNS CAN ONLY BE PLACED ON THE VENTS.

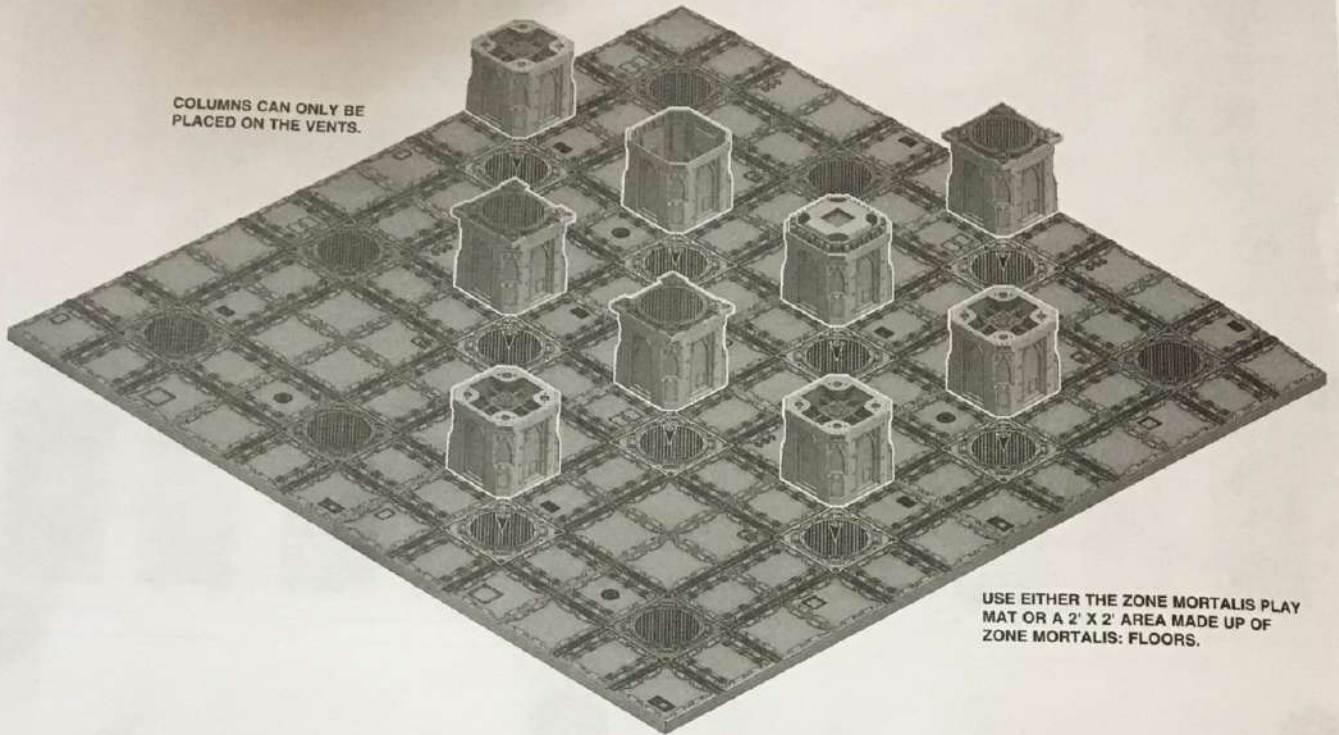

USE EITHER THE ZONE MORTALIS PLAY MAT OR A 2' X 2' AREA MADE UP OF ZONE MORTALIS: FLOORS.

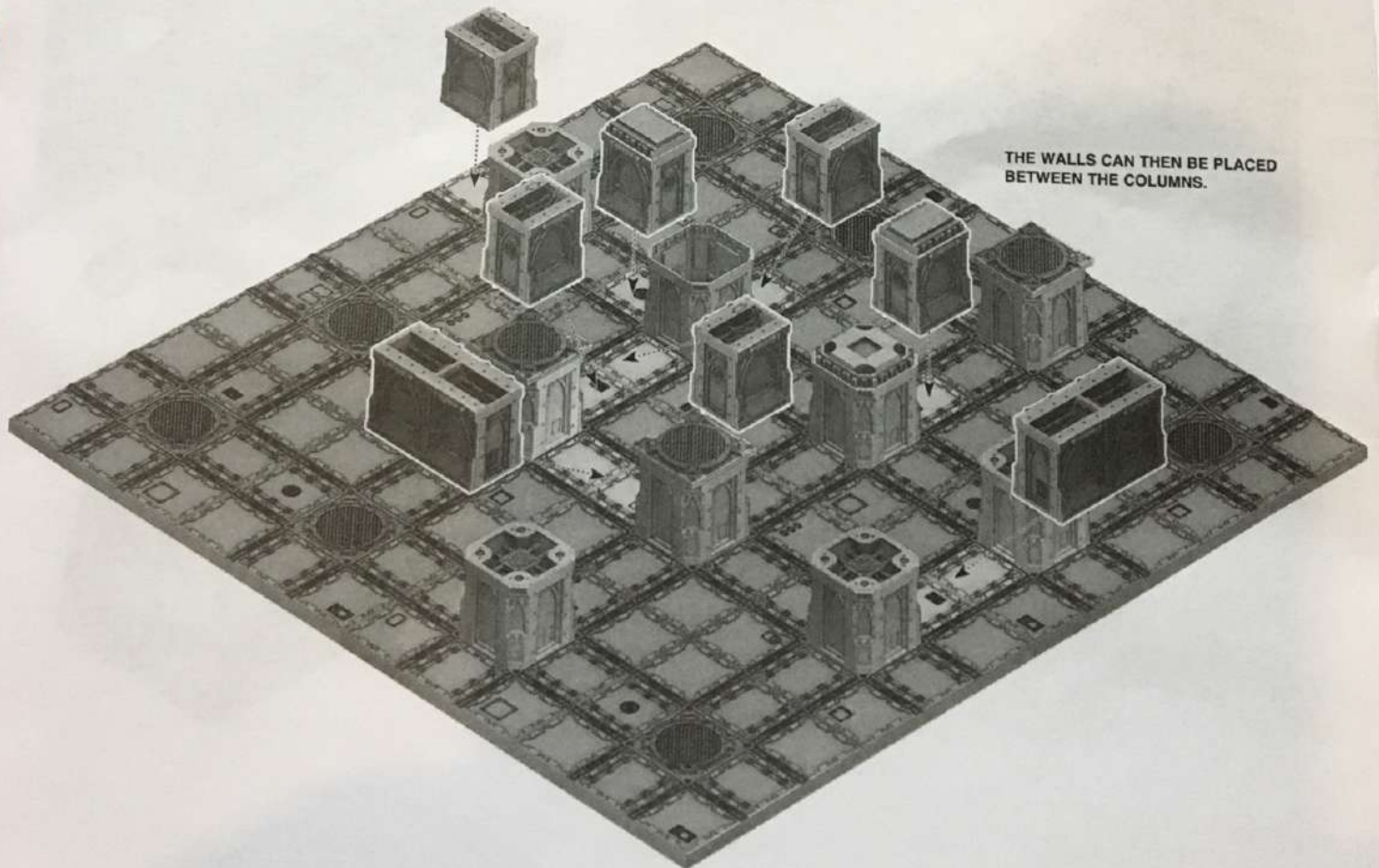

THE WALLS CAN THEN BE PLACED BETWEEN THE COLUMNS.

TOGETHER

COLUMNS AND WALLS  
PLATFORMS & STAIRS  
DOORS  
CONDUITS

**USING ZONE MORTALIS SCENERY AND THE THERMIC PLASMA CONDUITS SCENERY KITS TOGETHER**

SMALL DOORS CAN BE PLACED BETWEEN A SMALL WALL AND A COLUMN.

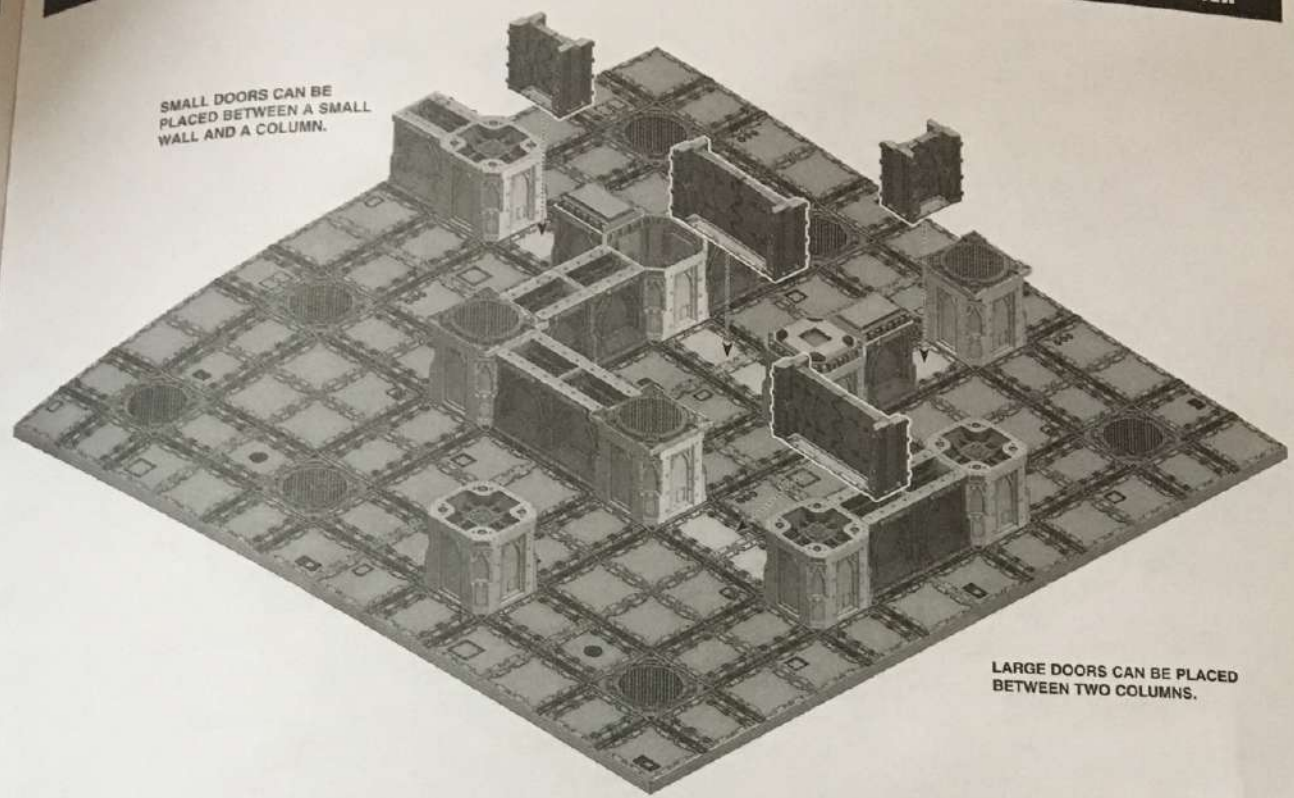

LARGE DOORS CAN BE PLACED BETWEEN TWO COLUMNS.

PLAY  
OF

STAIRS CAN BE PUT TOGETHER IN MANY WAYS.

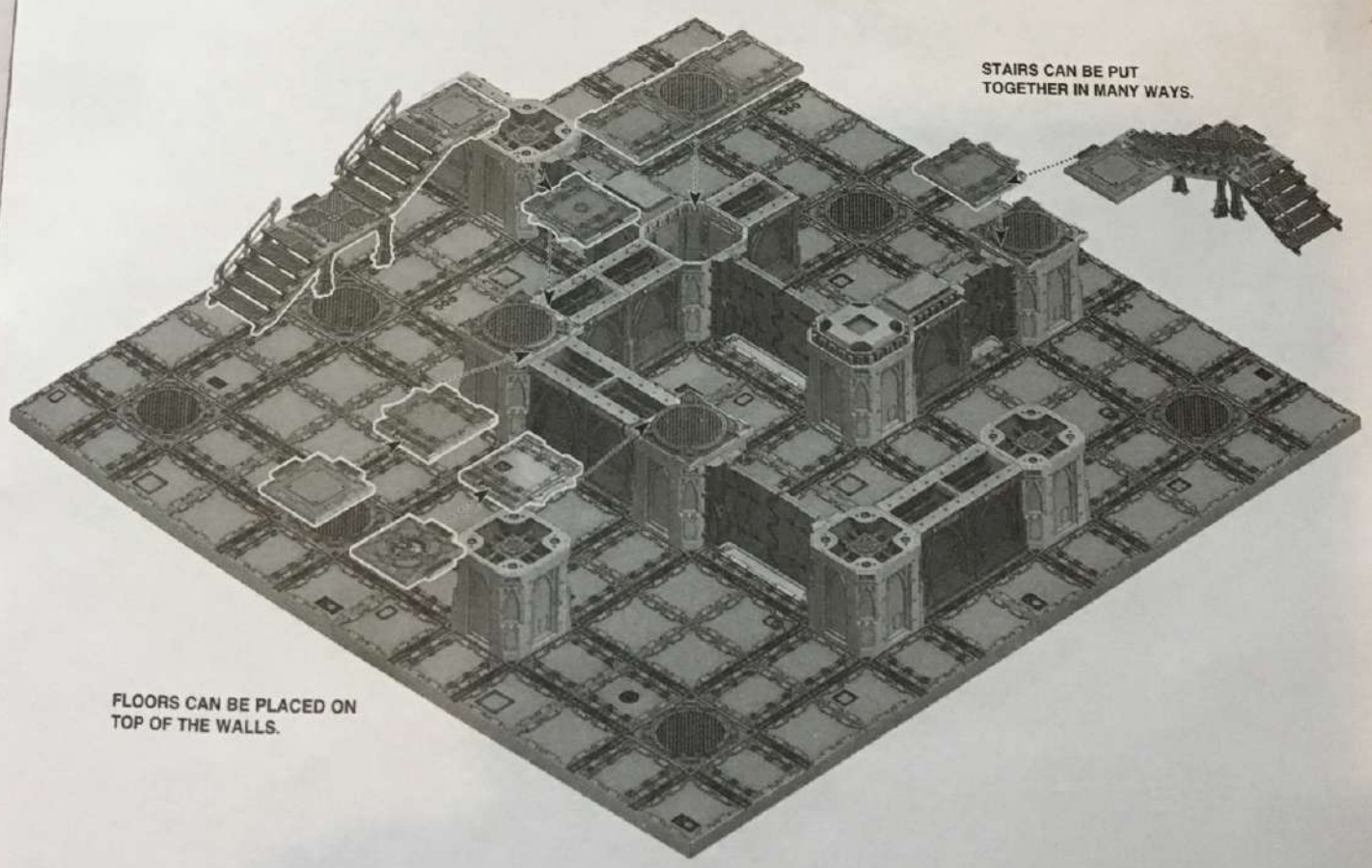

FLOORS CAN BE PLACED ON TOP OF THE WALLS.

**USING ZONE MORTALIS SCENERY AND THE THERMIC PLASMA CONDUITS SCENERY KITS TOGETHER**

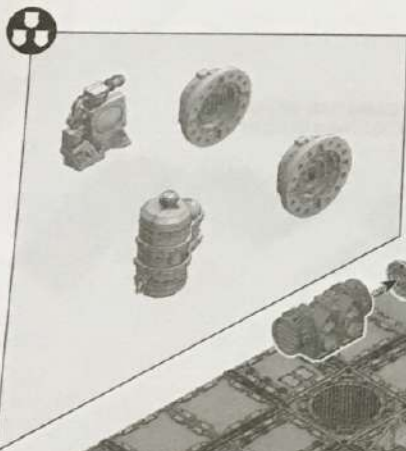
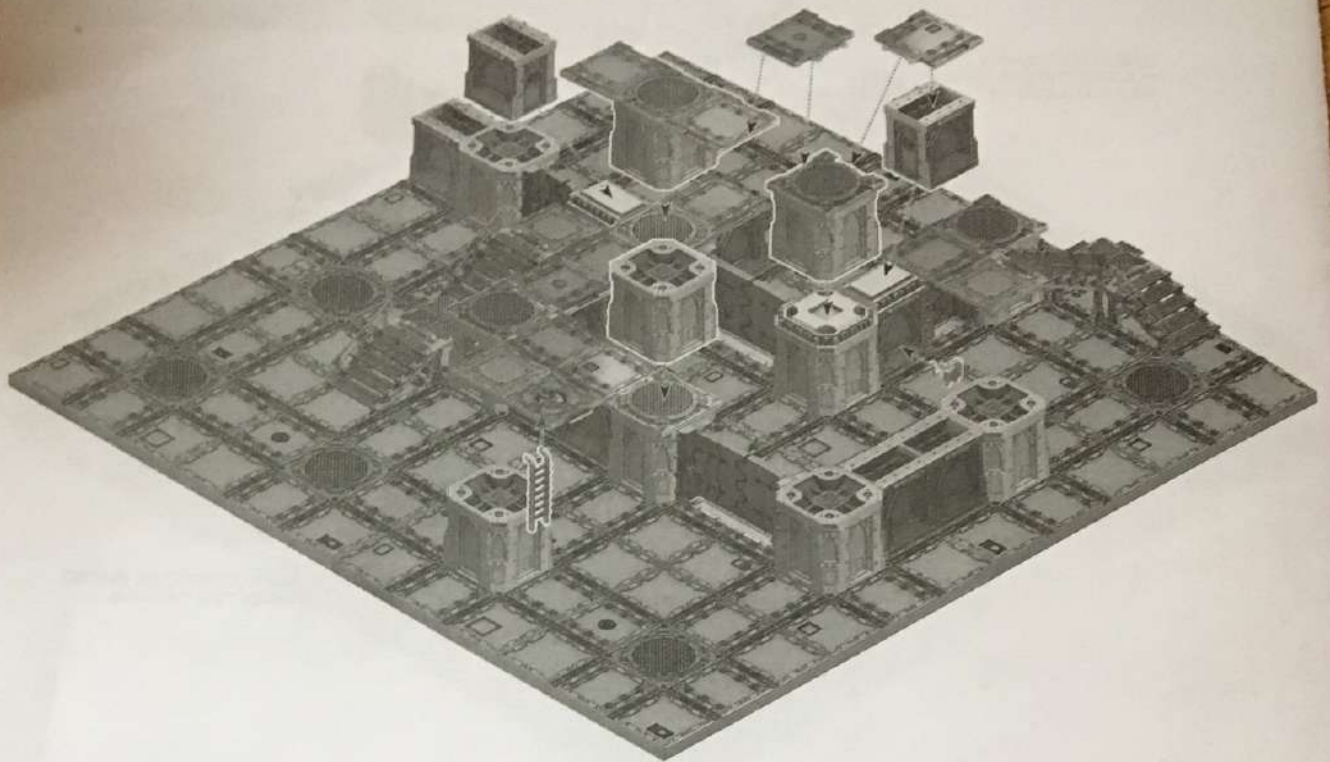

A DOUBLE LIFT  
CAN BE CREATED  
BY STACKING ONE  
COLUMN ON TOP OF  
ANOTHER.

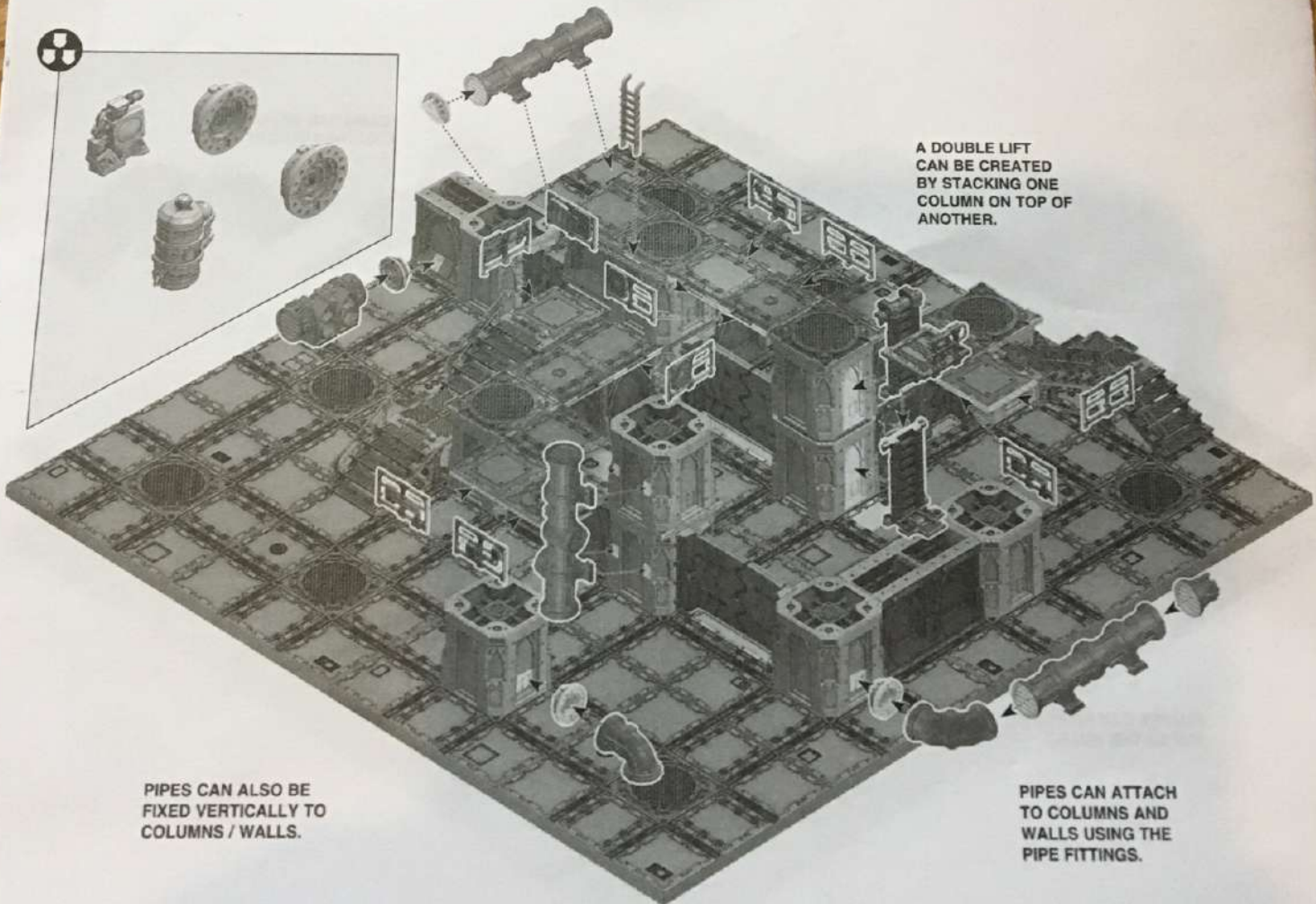

PIPES CAN ALSO BE  
FIXED VERTICALLY TO  
COLUMNS / WALLS.

PIPES CAN ATTACH  
TO COLUMNS AND  
WALLS USING THE  
PIPE FITTINGS.